

MARK.	ECN NO/DEFINITION	DATE	REVISE	APPROVE

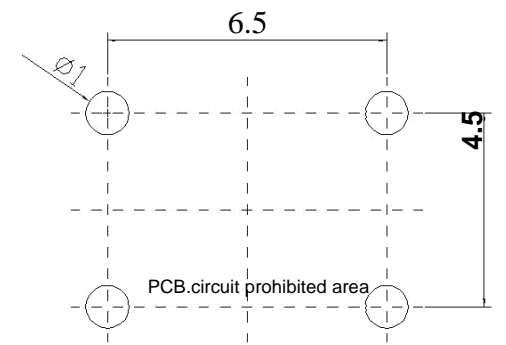
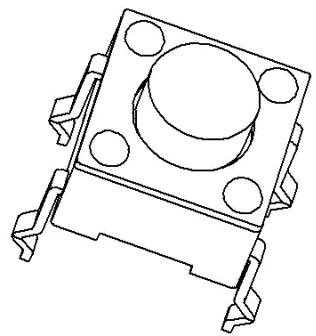
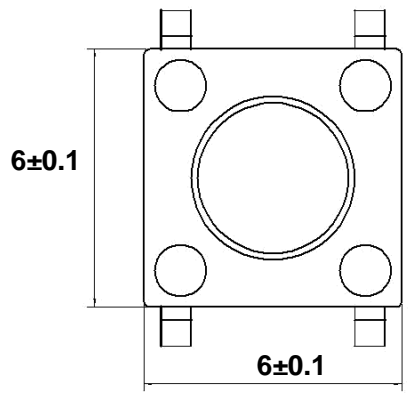
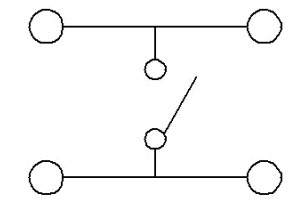
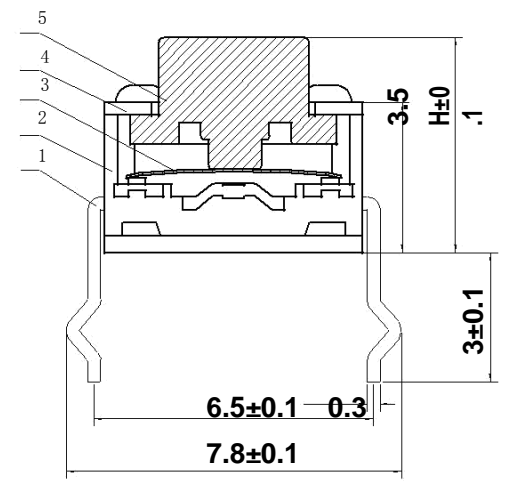
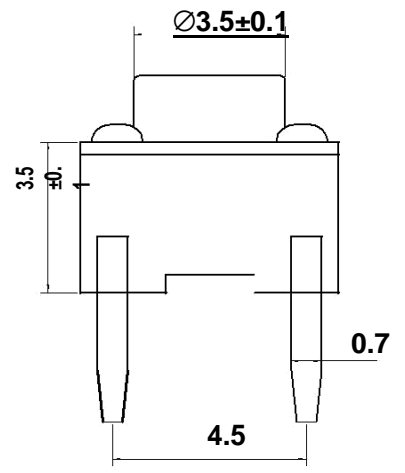

A  
B  
C  
D  
E  
F

Spec.	
Rating:	DC12V 50mA
Insulation resistance:	≥100MΩ 100V DC
Dielectric:	AC250V 50Hz/1min
Operation life:	50,000 cycles Min
Operating temp:	-25℃ ~ +76℃
Contact resistance:	≤100mΩ Max
Trave:	0.25±0.1mm
Operating force:	250gf±50gf
	160gf±50gf

No.	Name	Material	No.	
5	Button	PPA	1	Black
4	Cover	Fe/Cu	1	Sn plated Cu
3	Spring	SUS	1	Ag plated
2	Base	PPA	1	Black
1	Terminal	Brass	1	Ag plated

一般公差 GENERAL TOLERANCE			
X.	±0.2	X.°	±1°
.X	±0.1	.X°	±0.5°
.XX	±0.05	.XX°	±0.3°
.XXX	±0.02	.XXX°	

单位: UNIT		mm	
材质 MATERIAL		视图 VIEW	比例 SCALE
重量 WT.		图号 DWC NO.	1 : 1
		版本 REV.	A0
		日期	

产品名称 Product Title	轻触开关
产品系列 Product series	KAN0611 series
产品编码 MODEL NO	
张数 第 页	